

6

5

4

3

2

1

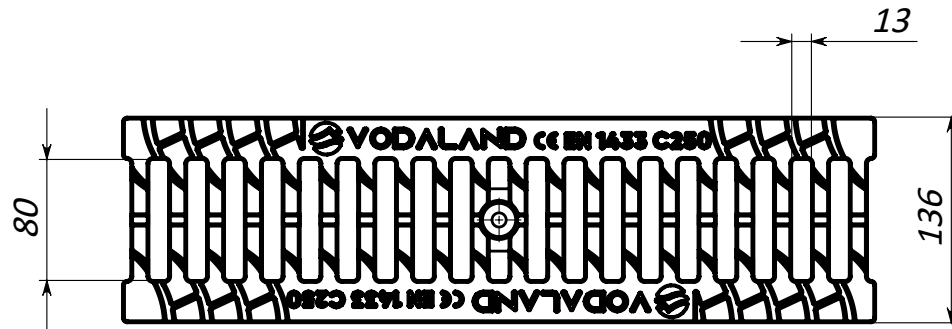
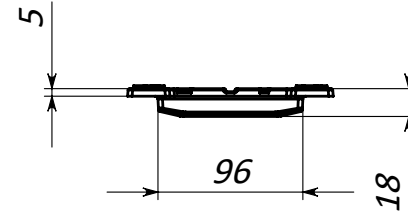
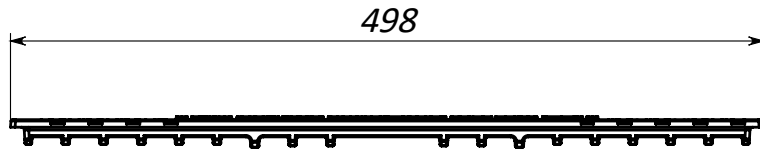

- 1. Area of water intake slots 199,52 sq cm ;
- 2. Deviation of the actual weight of the nominal can be up to 10%

UNLESS OTHERWISE SPECIFIED: DIMENSIONS ARE IN MILLIMETERS SURFACE FINISH: TOLERANCES: ISO 2768-c LINEAR: ANGULAR:				FINISH:		DO NOT SCALE DRAWING		REVISION		
						TITLE: Cast iron grate Base DN100 slotted Protector C250				
						Load class: C250				
						MATERIAL: Cast iron		Article: 203032		A4
						WEIGHT: 2.68 kg		SCALE:1:5		SHEET 1 OF 1

	NAME	SIGNATURE	DATE		
DRAWN	LMV		16.05.22		
CHK'D	LMK				
APPV'D					
MFG					
Q.A					

D

D

C

C

B

B

A

A

6

5

4

3

2

1